

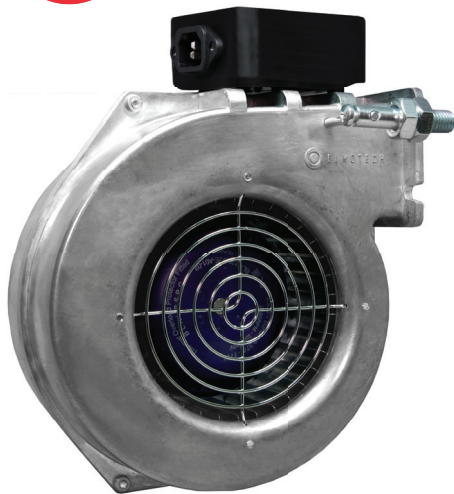

VFS-120

Forward curved centrifugal blowers in aluminum housing
 Short mounting flange
 Wheel diameter 120 mm
 Power supply: 230V 50Hz



Application: household and industrial heating systems

Temperature range: from -25 to +50 °C

Material: Electric motor – AC external rotor motor
 Housing – die cast aluminum alloy
 Impeller – galvanized steel

Insulation class: «B»

Bearings: industrial ball bearings, maintenance-free

Operation mode: continuous duty (S1)



| Type | Power input, W | Air flow, m ³ /h | Static pressure, Pa | Speed, min ⁻¹ | Motor capacitor, µF | Weight, kg |
|----------------|----------------|-----------------------------|---------------------|--------------------------|---------------------|------------|
| VFS-120-2E-B-1 | 77 | 244 | 283 | 2680 | 2 | 2,2 |
| VFS-120-2E-B-2 | 38 | 149 | 280 | 1650 | 0,68 | 2,2 |

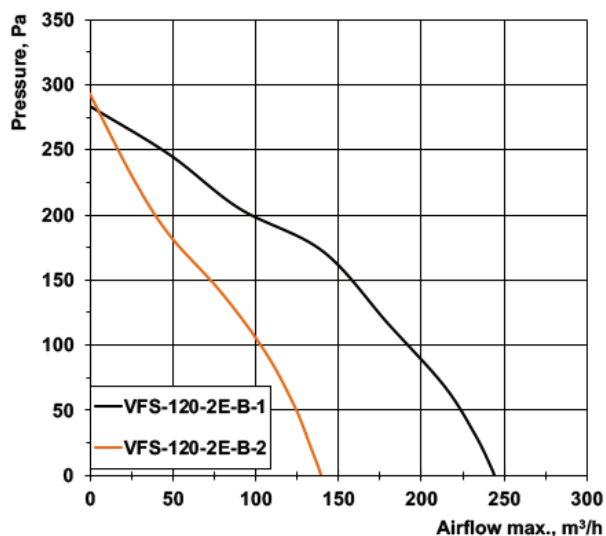
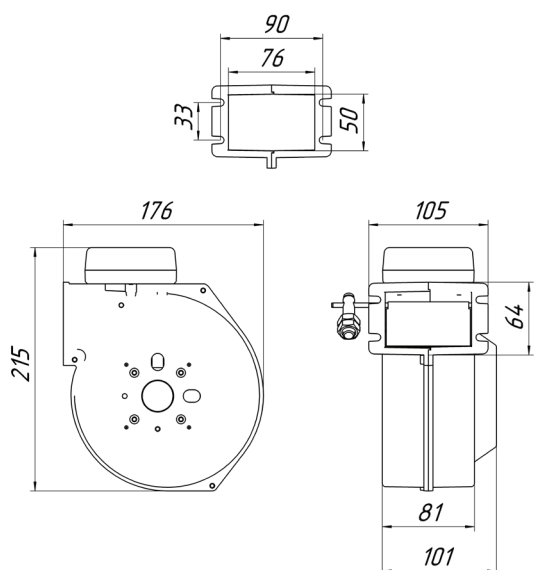

Additional options

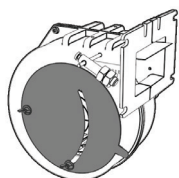

Shutter

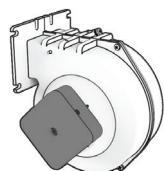

Junction Box on the Side

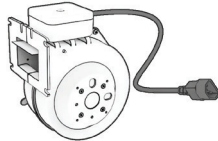

Longer Cable



Black Color Housing

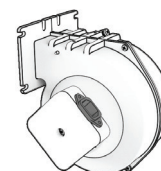

IEC Socket

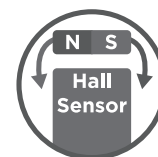

Hall Sensor



VFS-120

Forward curved centrifugal blowers in aluminum housing
 Short mounting flange
 Wheel diameter 120 mm
 Power supply: 24VDC



Application: household and industrial heating systems

Temperature range: from -25 to +50 °C

Material: Electric motor – BLDC external rotor motor
 Housing – die cast aluminum alloy
 Impeller – galvanized steel

Insulation class: «B»

Bearings: industrial ball bearings, maintenance-free

Operation mode: continuous duty (S1)



| Type | Power input, W | Air flow, m³/h | Static pressure, Pa | Speed, min ⁻¹ | Speed Control | Weight, kg |
|----------------|----------------|----------------|---------------------|--------------------------|---------------|------------|
| VFS-120-DC-B-1 | 55 | 250 | 300 | 2700 | 0-10V | 2,2 |

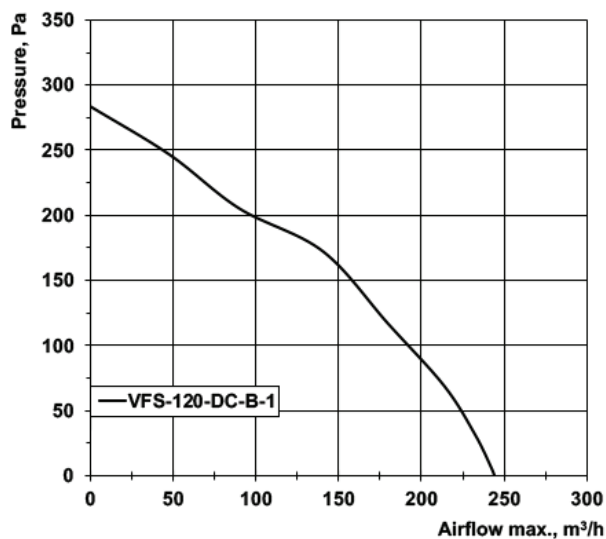
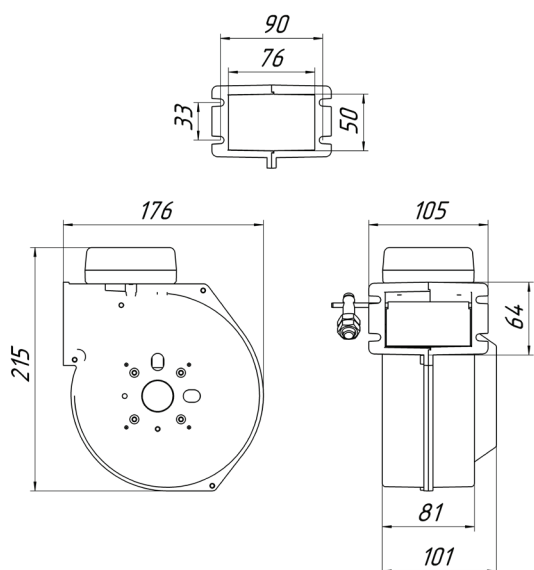

Additional options

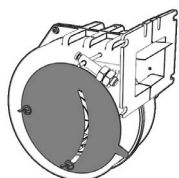

Shutter

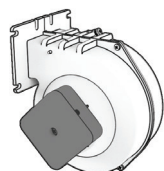

Junction Box on the Side

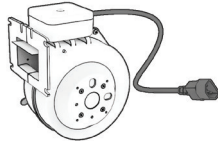

Longer Cable



Black Color Housing

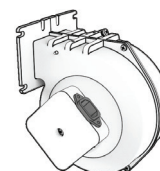

IEC Socket

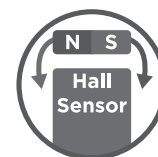

Hall Sensor



VFS-120

Forward curved centrifugal blowers in aluminum housing
 Short mounting flange
 Wheel diameter 120 mm
 Power supply: 230V 50Hz



Application: household and industrial heating systems

Temperature range: from -25 to +50 °C

Material: Electric motor – EC external rotor motor
 Housing – die cast aluminum alloy
 Impeller – galvanized steel

Insulation class: «B»

Bearings: industrial ball bearings, maintenance-free

Operation mode: continuous duty (S1)



| Type | Power input, W | Air flow, m³/h | Static pressure, Pa | Speed, min ⁻¹ | Speed Control | Weight, kg |
|----------------|----------------|----------------|---------------------|--------------------------|---------------|------------|
| VFS-120-EC-B-1 | 86 | 340 | 400 | 2800 | 0-10V / PWM | 2,2 |

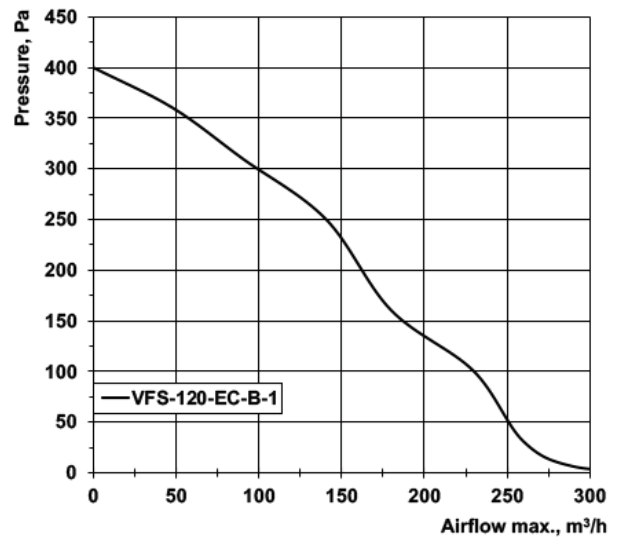
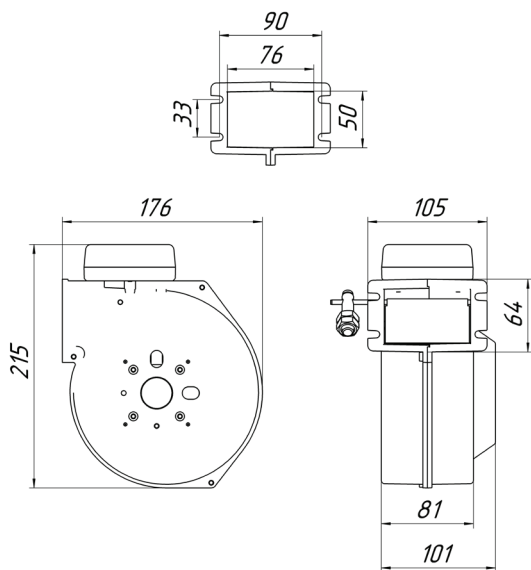

Additional options

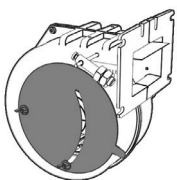

Shutter

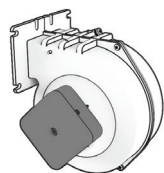

Junction Box on the Side

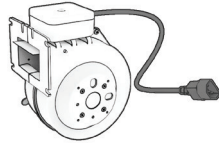

Longer Cable

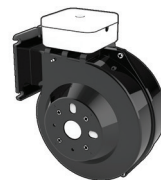

Black Color Housing

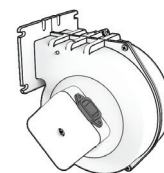

IEC Socket

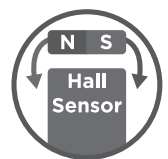

Hall Sensor