



VFS-120

Forward curved centrifugal blowers in aluminum housing
 Short mounting flange
 Wheel diameter 120 mm
 Power supply: 230V 50Hz



Application: household and industrial heating systems

Temperature range: from -25 to +50 °C

Material: Electric motor – EC external rotor motor
 Housing – die cast aluminum alloy
 Impeller – galvanized steel

Insulation class: «B»

Bearings: industrial ball bearings, maintenance-free

Operation mode: continuous duty (S1)



| Type | Power input, W | Air flow, m³/h | Static pressure, Pa | Speed, min ⁻¹ | Speed Control | Weight, kg |
|----------------|----------------|----------------|---------------------|--------------------------|---------------|------------|
| VFS-120-EC-B-1 | 86 | 340 | 400 | 2800 | 0-10V / PWM | 2,2 |

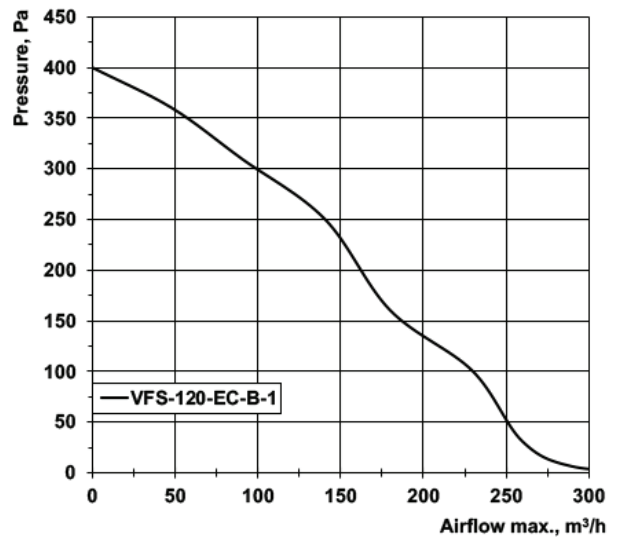
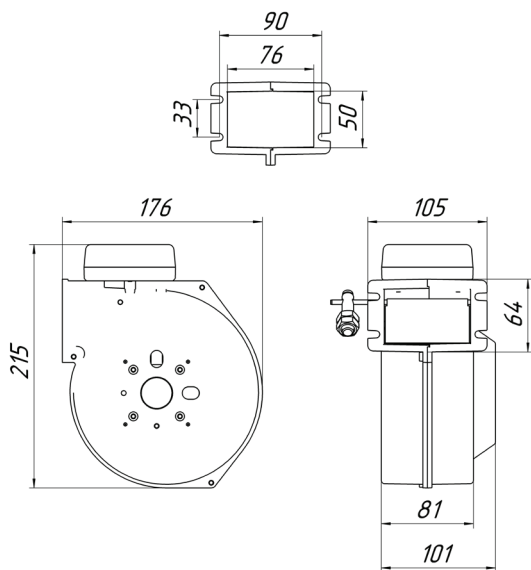

Additional options

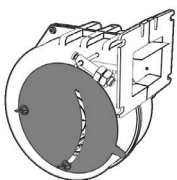

Shutter

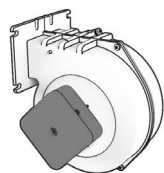

Junction Box on the Side

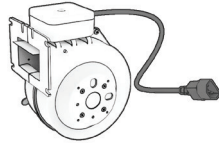

Longer Cable



Black Color Housing

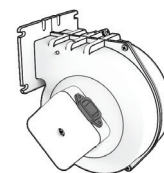

IEC Socket

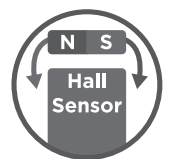

Hall Sensor